

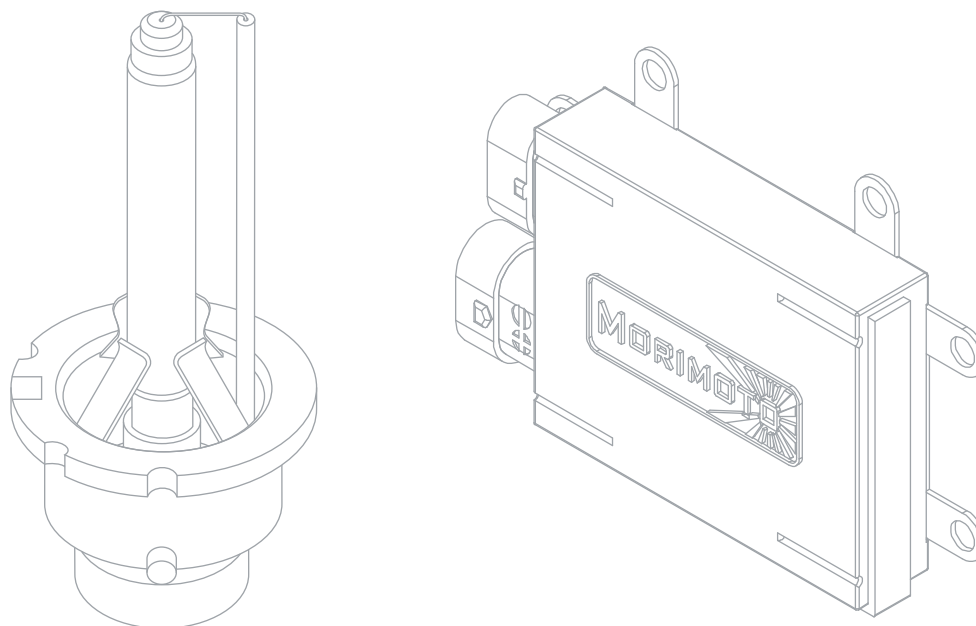

THE AUTOMOTIVE LIGHTING BENCHMARK



INSTALLATION GUIDE

D2S ELITE HID SYSTEM



WARNING: By reading this document, I agree it is only to be used as an educational guide. Morimoto Lighting makes no guarantee on any finished results, nor are they to be held responsible for any damage, misuse, or personal injuries. Use at your own risk. If you are unable to clearly understand and adapt the information below to your own application, professional installation is recommended.

TABLE OF CONTENTS

SYSTEM DIAGRAM (CHOOSE YOURS) P.3

EXTERNALLY-WIRED W/ CANBUS P.4

EXTERNALLY-WIRED W/ HD RELAY P.5

INTERNALLY-WIRED W/ CANBUS P.6

INTERNALLY-WIRED W/ HD RELAY P.7

DUAL FILAMENT W/ MOTOCONTROL P.8







DUAL FILAMENT W/ CANBUS P.9

HARNESS INSTALLATION P.10

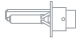
BULB INSTALLATION P.10

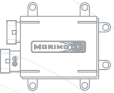
BALLAST INSTALLATION P.11

STANDARD PARTS

	1 X TEST LEAD
	2 X HID BULBS
	2 X D2S IGNITERS
	2 X BALLAST COMPUTERS
AND YOUR CHOICE OF:	
	2 X CANBUS HARNESSES
OR	
	1 X HD RELAY HARNESS
OR	
	1 X MOTOCONTROL HARNESS

OPTIONAL PARTS

	1 X CAPACITOR LINK
	2 X CARBON FIBER BALLAST BRACKETS

SPECIAL NOTE:

The included ballast test lead is used for troubleshooting purposes only and is not part of the installation of this system. If necessary, the test lead can be plugged into the ballast input then connected to a 12V+ source to test the ballast. This must be done with the bulb connected to the ballast prior to applying power.



Ballast Test Lead



NOTE: System diagrams are to be used for reference purposes only. If you are unsure of the installation procedure for any individual part, review its install procedure prior to proceeding.

IDENTIFYING YOUR INSTALLATION TYPE



NOTE: There are three types of wiring installations with this system: EXTERNAL LOW-BEAM, INTERNAL LOW-BEAM, and DUAL FILAMENT. The installation guide that follows will cover all three types.

EXTERNAL LOW-BEAM

Separate low and high beam bulbs; When you can access the bulb from the back of the headlight without removing any caps or covers. Wiring for the bulb is visible and accessible outside of the housing.



PROCEED TO PAGE 4

INTERNAL LOW-BEAM

Separate low and high beam bulbs; When you must first remove a cap (generally plastic) to access the bulb. Inside the housing, there is wiring going to the bulb.

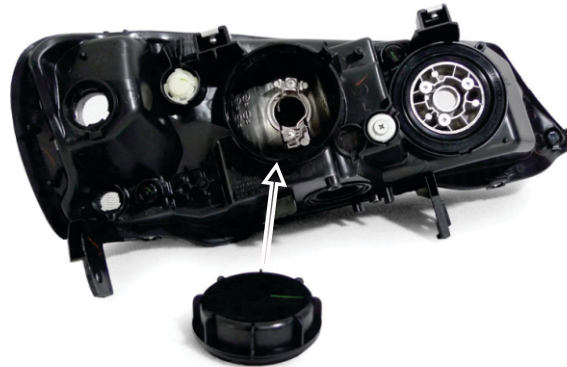

PROCEED TO PAGE 6

DUAL FILAMENT

Shared low/high beam bulb; You can access the bulb from the back of the headlight without removing any caps or covers. Wiring for the bulb is visible and accessible outside of the housing.



PROCEED TO PAGE 8

EXTERNALLY-WIRED W/ STANDALONE CANBUS

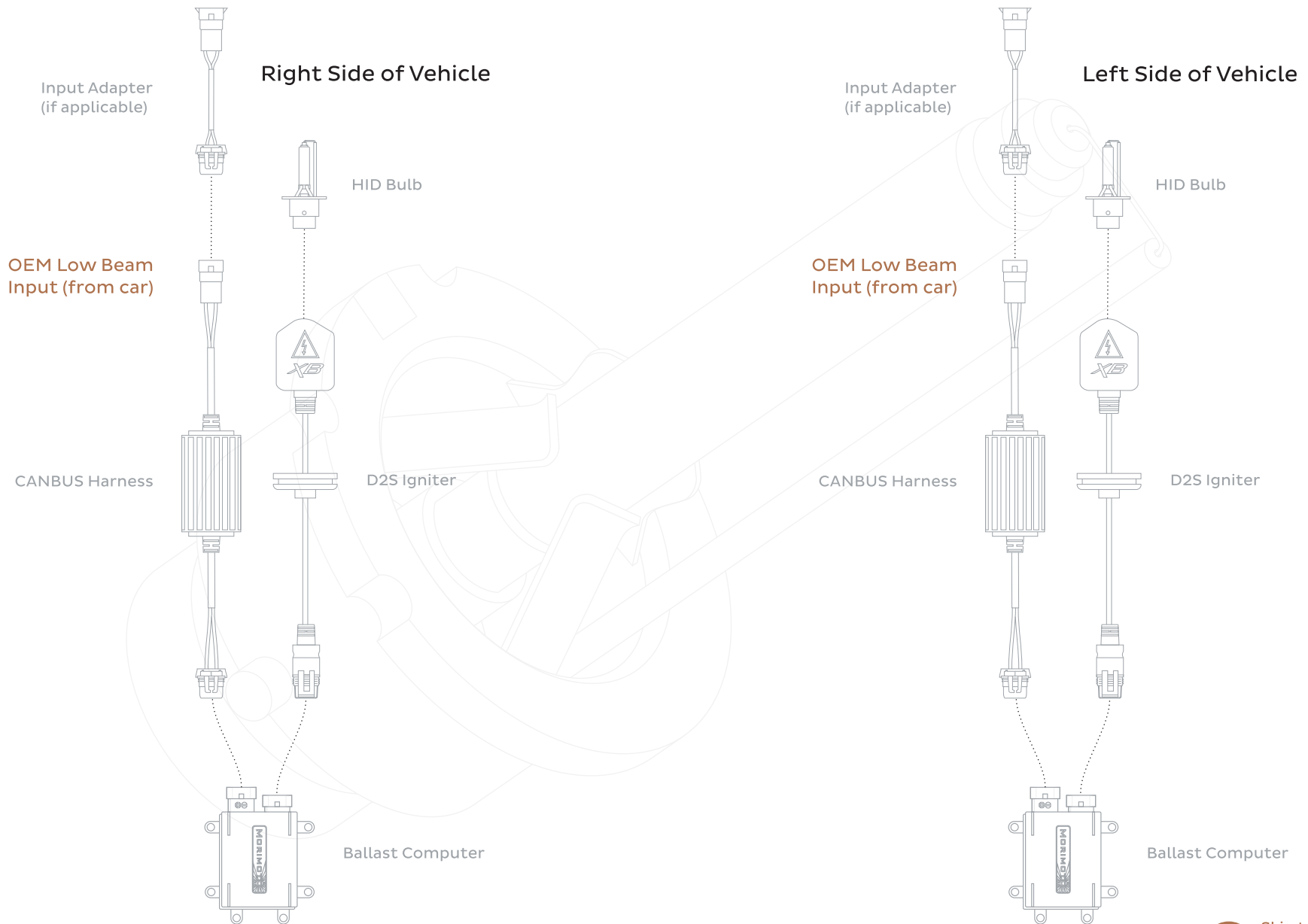

 Skip to Page 10 for component-specific procedures

EXTERNALLY-WIRED W/ HD RELAY HARNESS

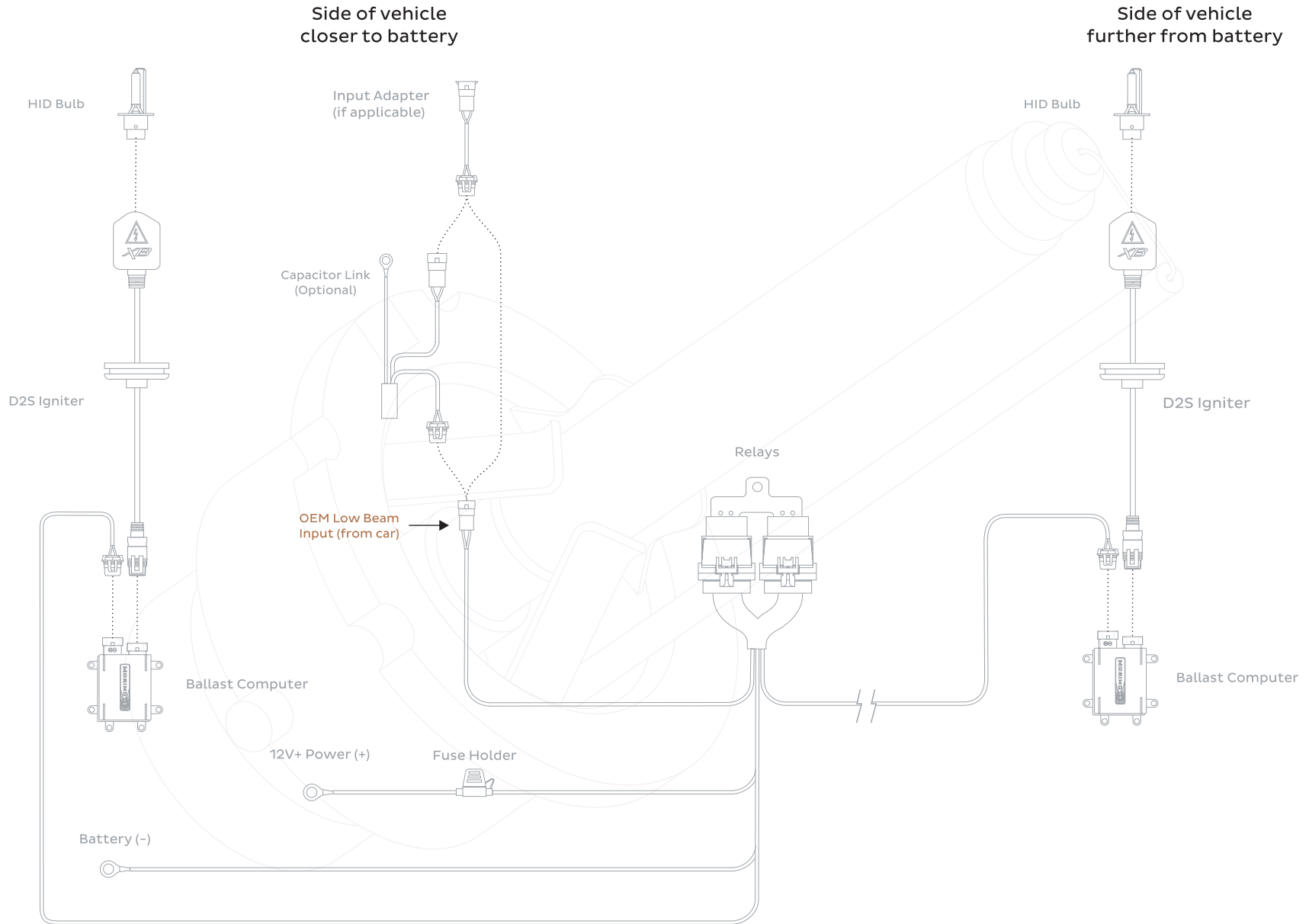

 Skip to Page 10 for component-specific procedures

INTERNALLY-WIRED W/ STANDALONE CANBUS

Right Side of Vehicle

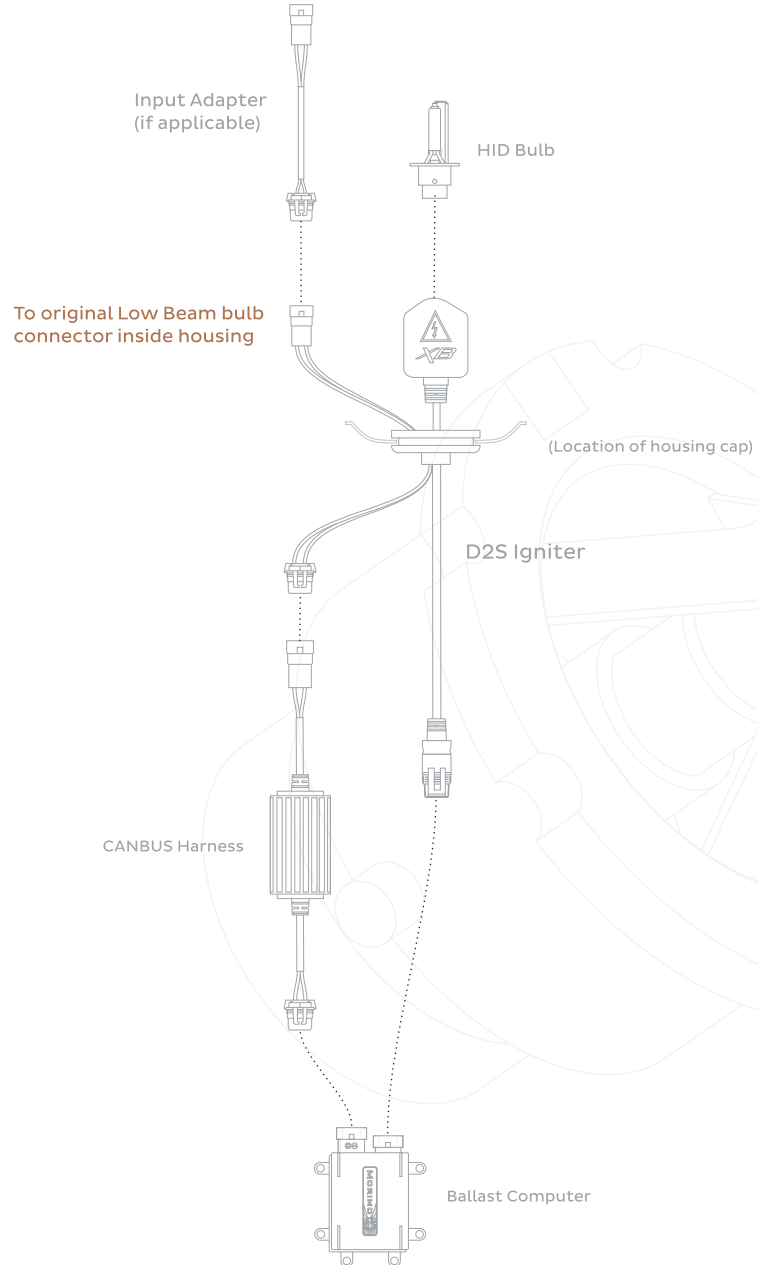

Left Side of Vehicle

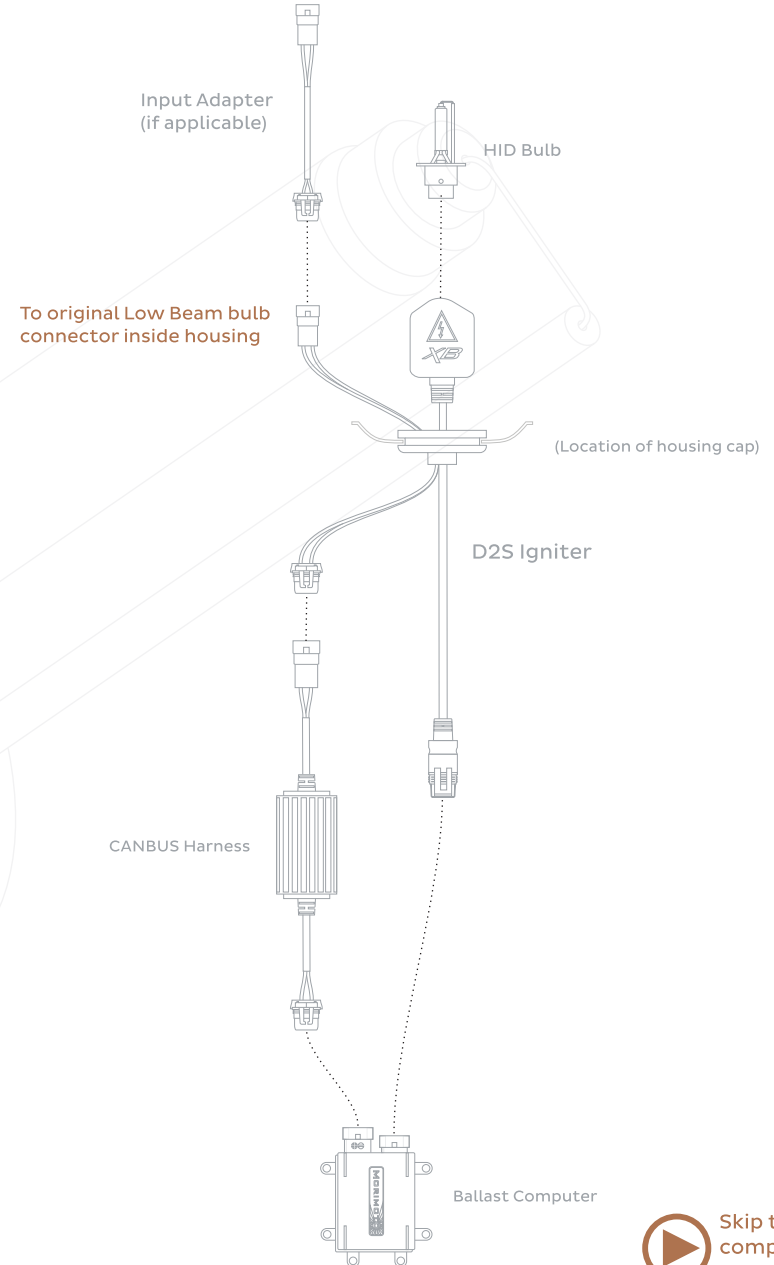

 Skip to Page 10 for component-specific procedures

INTERNALLY-WIRED W/ HD RELAY HARNESS

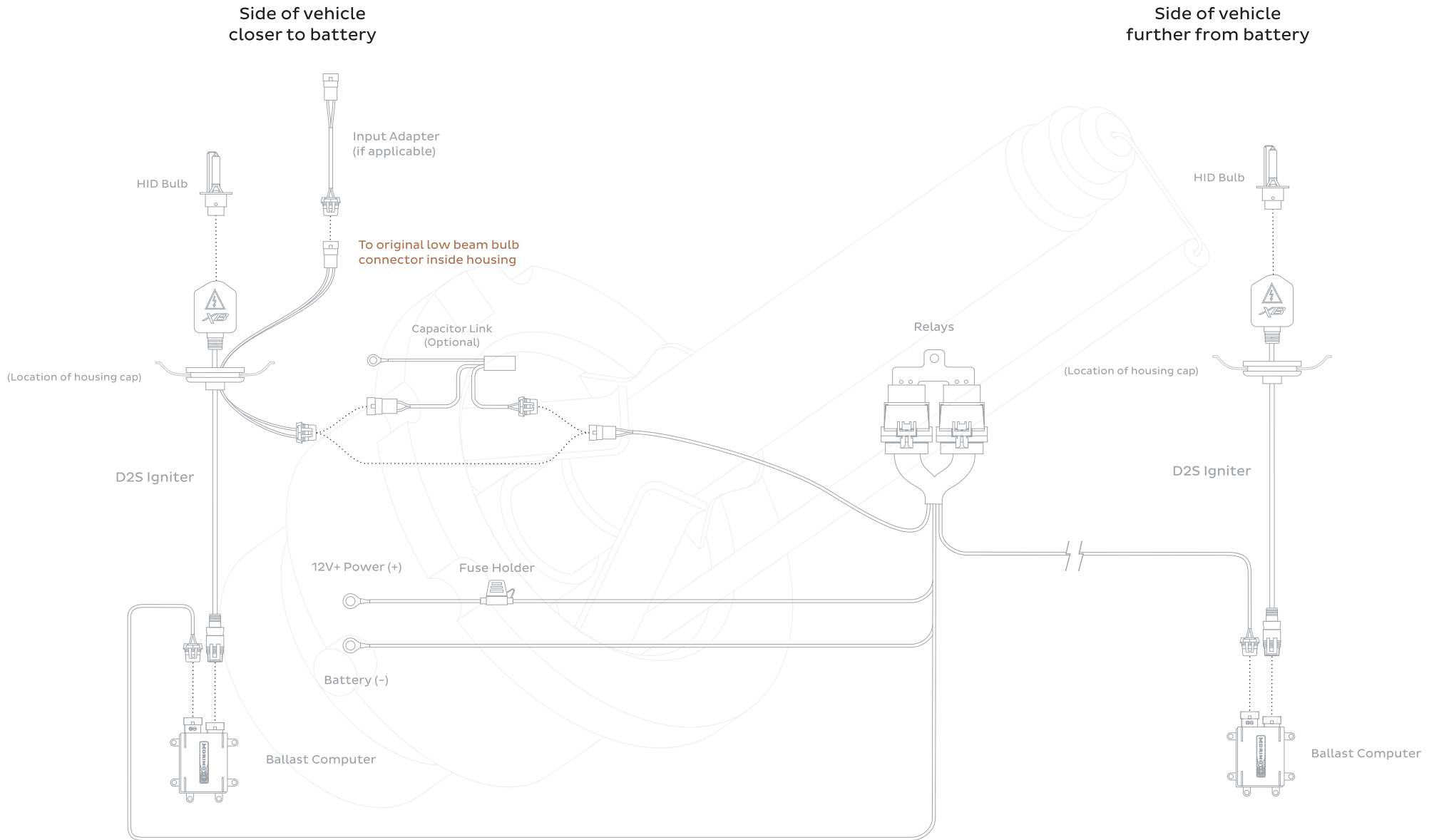

 Skip to Page 10 for component-specific procedures

DUAL FILAMENT WITH MOTOCONTROL HARNESS

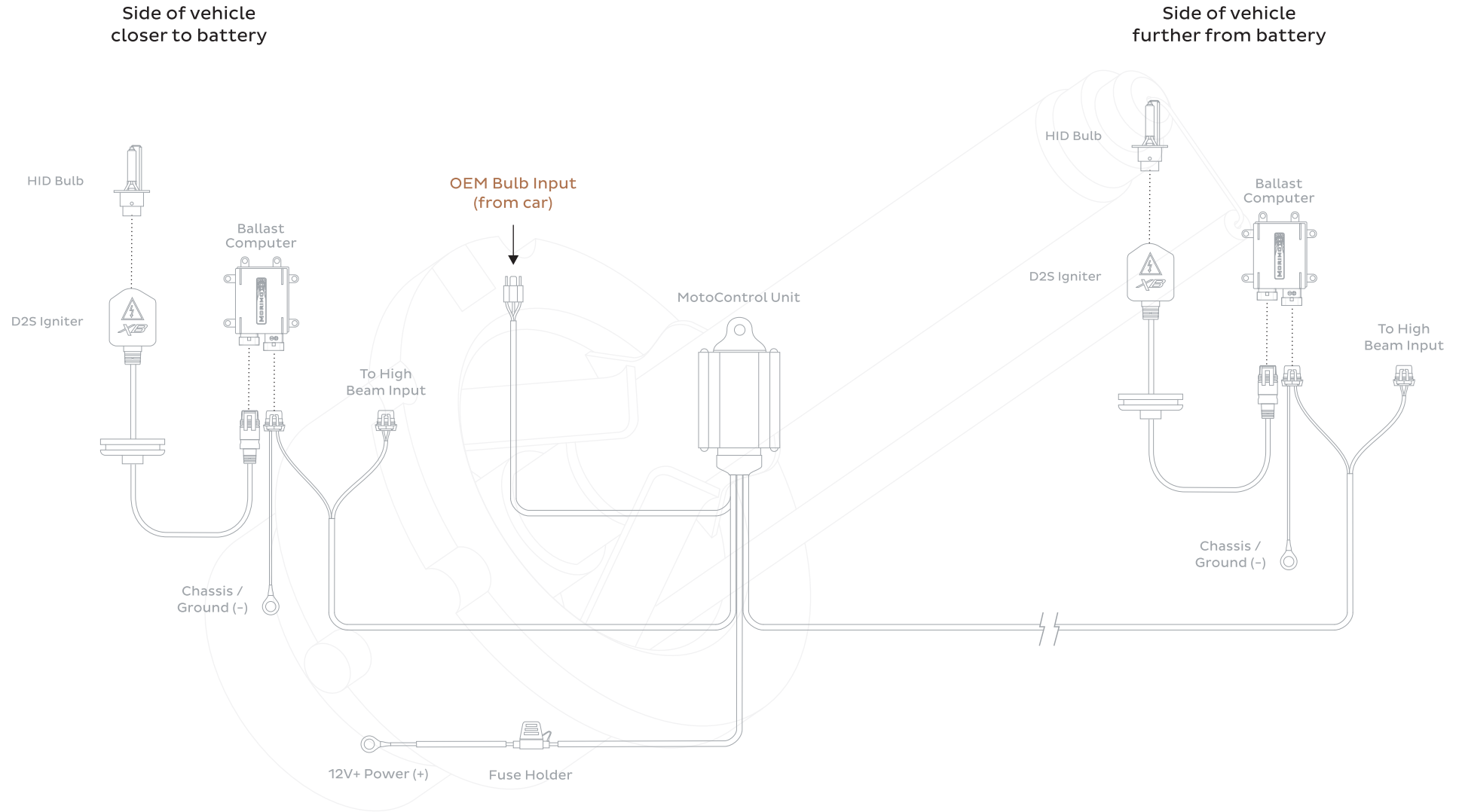

 Skip to Page 10 for component-specific procedures

DUAL FILAMENT WITH STANDALONE CANBUS

Right Side of Vehicle

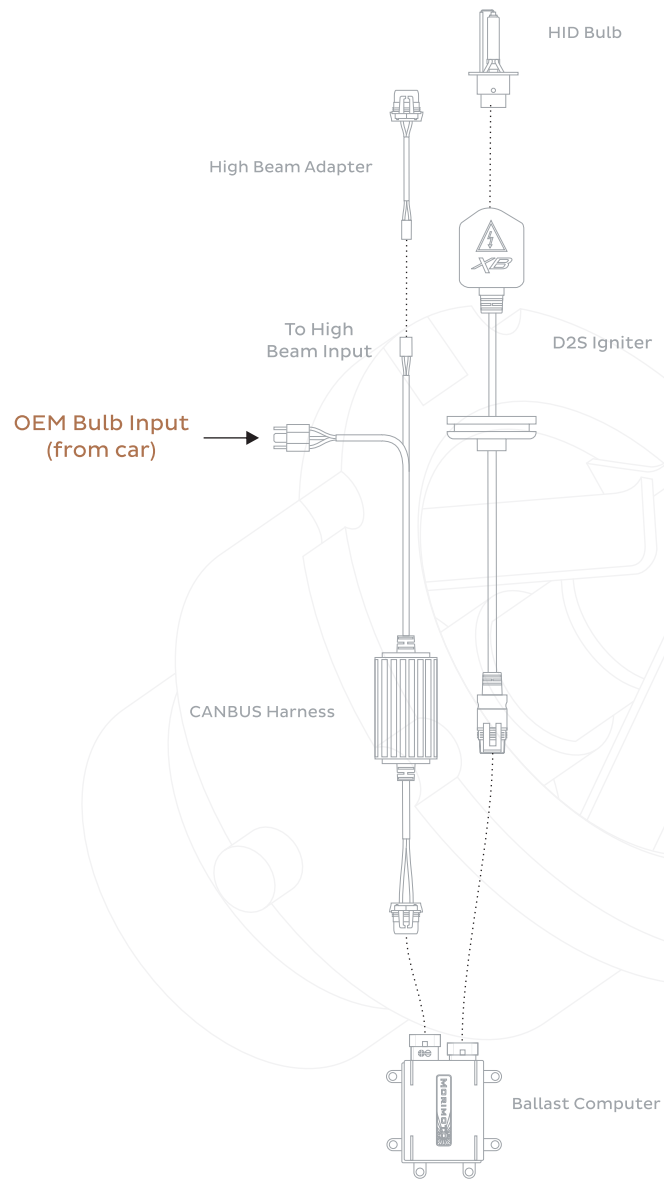

Left Side of Vehicle

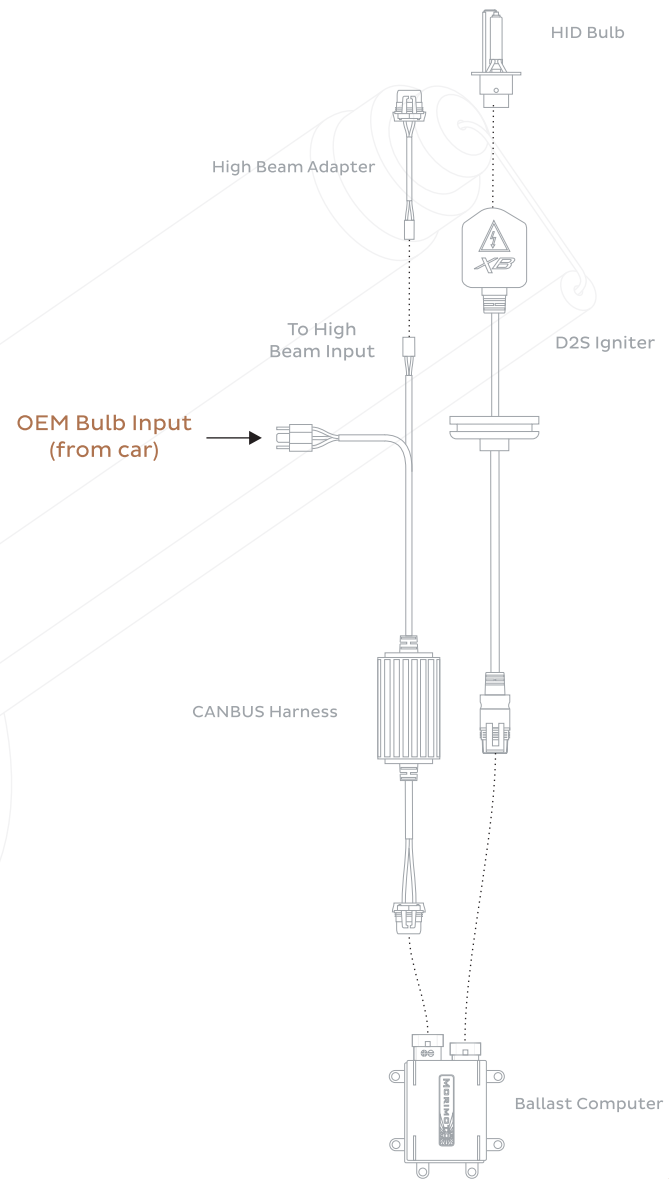

 Skip to Page 10 for component-specific procedures

HARNESS INSTALLATION

ALL HARNESS TYPES

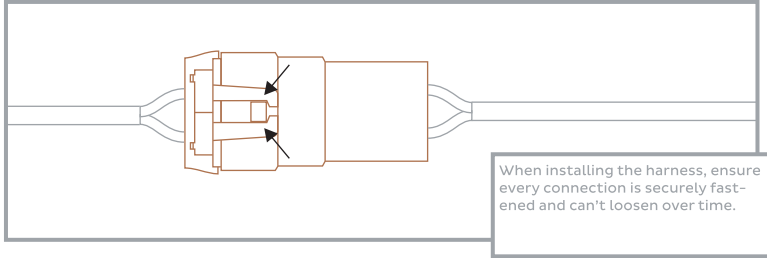

OPTIONAL ANTI-FLICKER CAPACITOR LINK

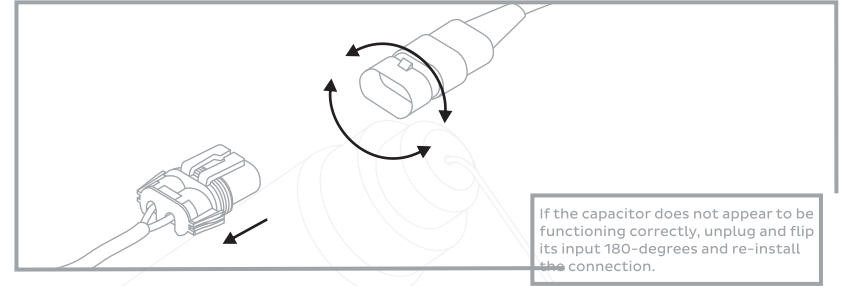

ALL HD RELAY AND MOTOCONTROL HARNESSES

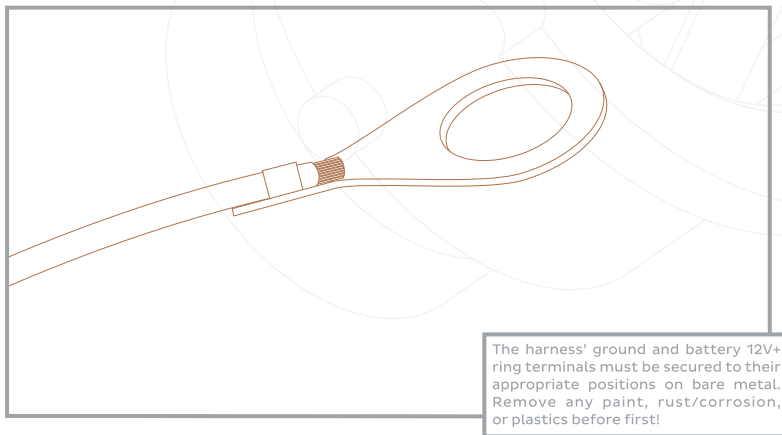
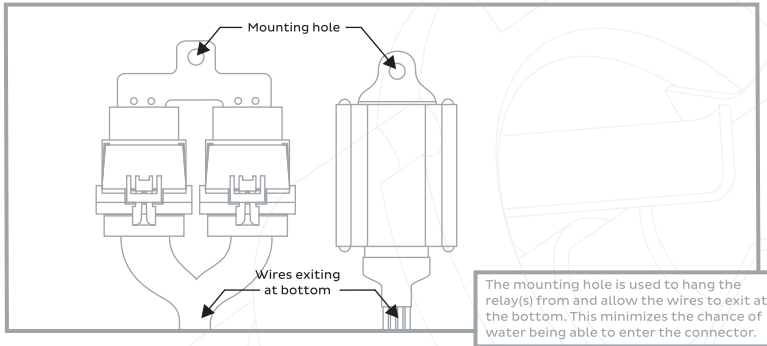

BULB INSTALLATION



CAUTION: HOT!



HANDLE ONLY WITH BLACK PLASTIC BASE

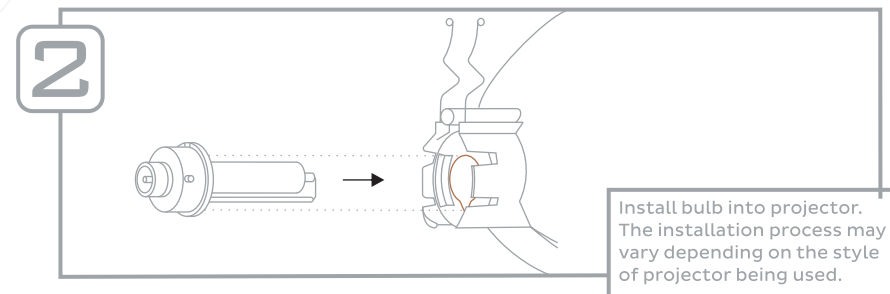
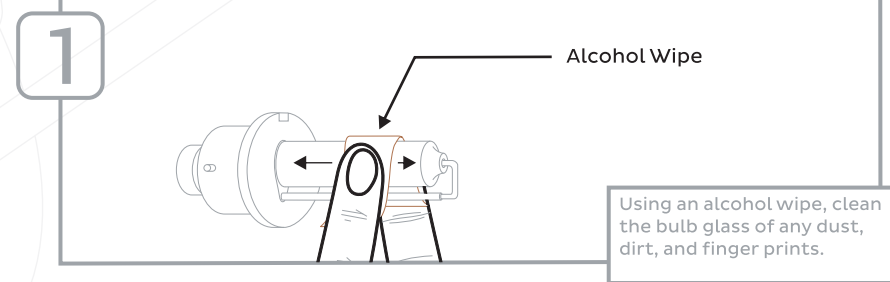

BALLAST INSTALLATION



DO NOT IGNITE UNTIL FULLY CONNECTED!



WATERPROOF

1

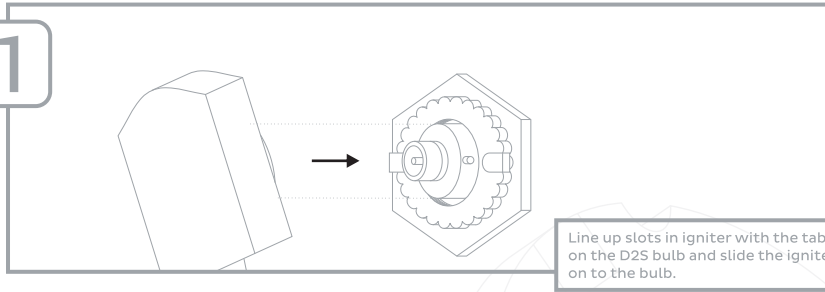

Line up slots in igniter with the tabs on the D2S bulb and slide the igniter on to the bulb.

2

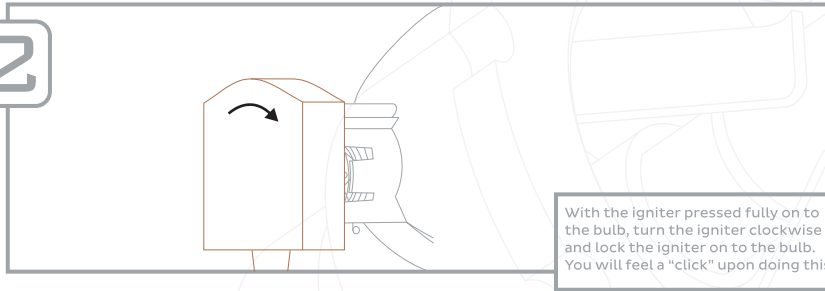

With the igniter pressed fully on to the bulb, turn the igniter clockwise and lock the igniter on to the bulb. You will feel a "click" upon doing this.

IS YOUR SETUP...

EXTERNALLY WIRED or DUAL FILAMENT?



INTERNALLY WIRED?

SKIP TO PAGE 13, STEP 12

PROCEED AT RIGHT

STEP BY STEP - INTERNALLY WIRED

3

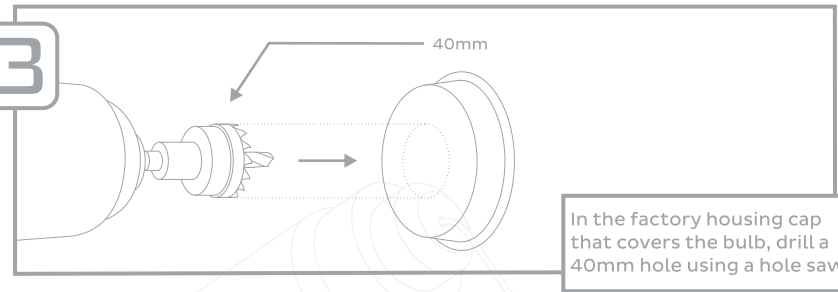

In the factory housing cap that covers the bulb, drill a 40mm hole using a hole saw.

4

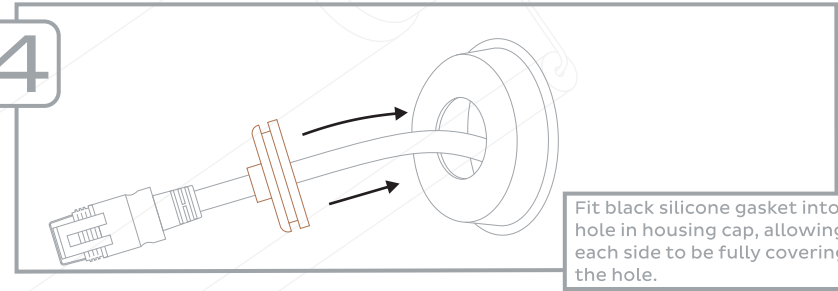

Fit black silicone gasket into hole in housing cap, allowing each side to be fully covering the hole.

ARE YOU USING...

HD RELAY HARNESS?



STANDALONE CANBUS HARNESSES?

COMPLETE STEPS 5-7 ON SIDE OF VEHICLE CLOSER TO BATTERY ONLY

COMPLETE STEPS 5-7 ON BOTH SIDES OF VEHICLE

5

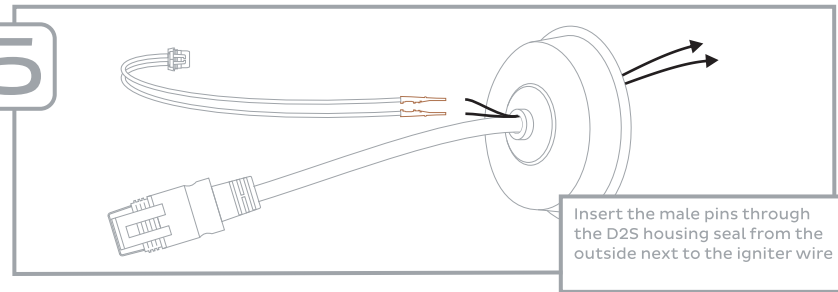

Insert the male pins through the D2S housing seal from the outside next to the igniter wire

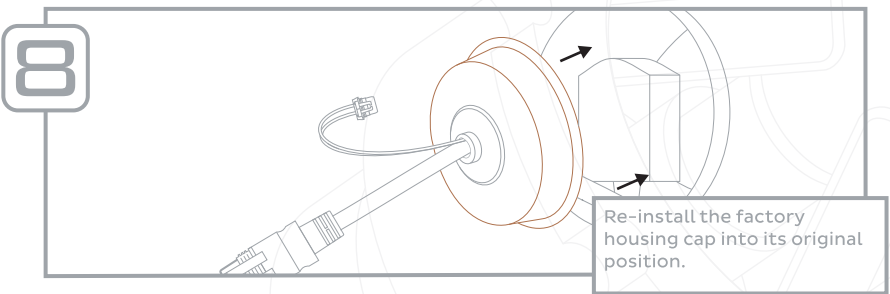
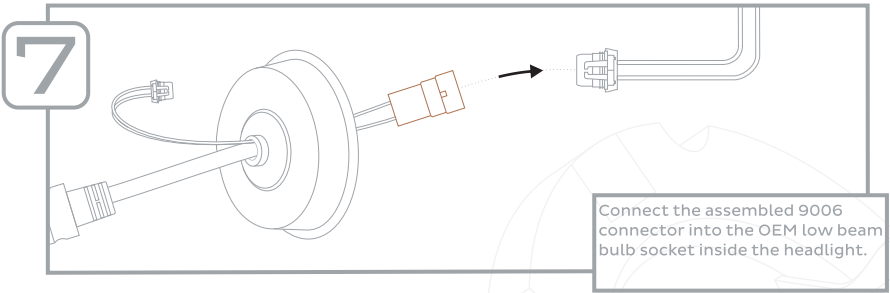
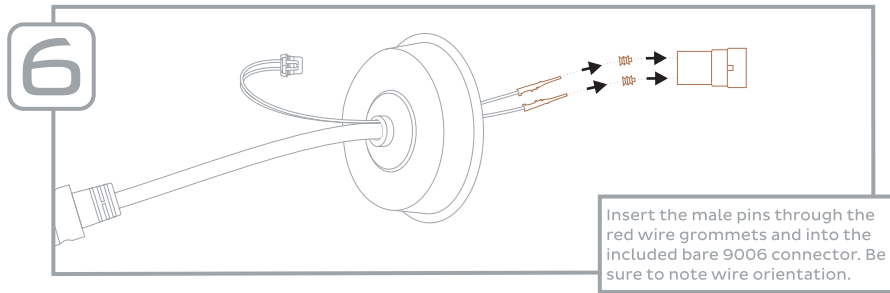

ARE YOU USING...



HD RELAY HARNESS?

STANDALONE CANBUS HARNESSES?

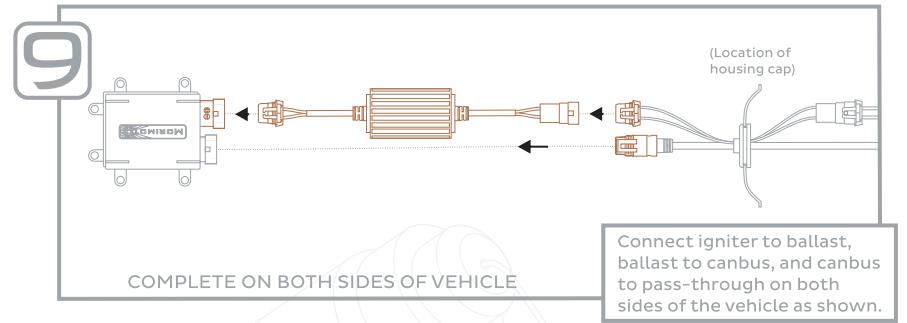

▶ Skip to step 12

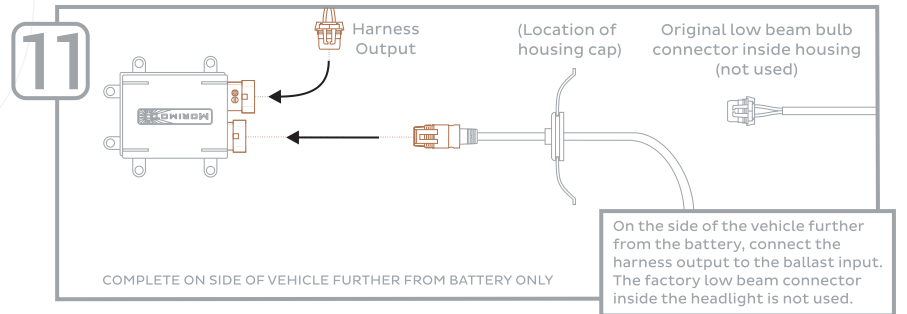
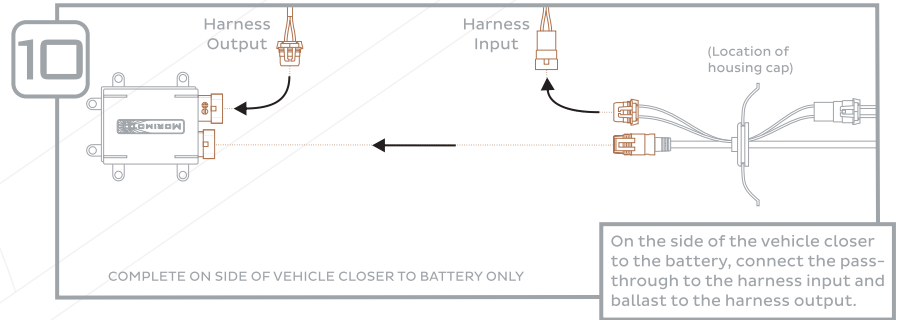

12



Listen for click of connectors to ensure fully seated!

13

Recommended mounting:

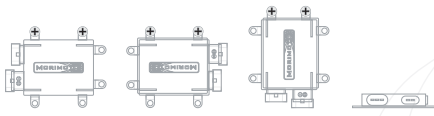

Do not mount ballast with connectors aimed upward!

-END-

