



## INSTALLATION INSTRUCTIONS

### VEHICLE APPLICATION

Year: 2016 - 2017  
 Make: Nissan  
 Model: Titan XD  
 Engine: Cummins 5.0L V8 Turbo Diesel

### TOOLS REQUIRED

- 10mm, 13mm Wrench/Socket
- 5/16" Nut Driver or Flat Blade Screwdriver
- Phillips Screwdriver
- Pliers
- Flashlight

### S&B FILTER MAINTENANCE

- Cleanable (KF-1063). If the enclosed filter is Red, it came pre-oiled from the factory. Please visit [www.sbfilters.com](http://www.sbfilters.com) for exact oil amount required after cleaning.
- Disposable (KF-1063D). If the enclosed filter is White, it is a disposable filter and should be discarded once it reaches capacity. This filter (does not require oil). For more info on S&B's disposable filter, visit [www.sbfilters.com](http://www.sbfilters.com).

### NOTES

Kit may not fit with the following Aftermarket Parts installed:

- Body Lift or Lowering Kit
- Custom Hood
- Throttle Body Spacer/ Upgrade

### CARB STATUS - Pending

Product will be submitted to Air Resources Board for approval shortly.

Not Legal for use in CA or other states adopting CA emissions standards" See Page 4 for more info.

### BEFORE YOU START

- Please read the entire product guide before proceeding.
- Ensure all components listed on page 5 are present.
- If you are missing any of the components, call our customer support at (909) 947-0015.
- Do not work on your vehicle while engine is hot.
- Make sure the engine is turned off and the vehicle is in Park or the Parking Brake is set.

1. With the ignition switched off and the parking brake set, disconnect the negative battery cables on both batteries. **Note: Failure to disconnect the battery may cause the CEL to illuminate upon completion of the installation and subsequent operation. Do not skip this step!**

2. Rotate the negative battery cable on the driver side towards the front of the vehicle as shown below. Loosen the screw mounting the ground wire to the fender with a 10mm wrench. Do not connect any battery cables yet.

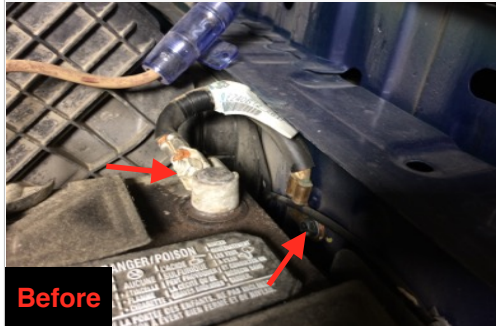

Before



After

3. Disconnect the wire harness to the MAF sensor and IAT sensor. Press down on the connector and pull out the wire harness for the IAT sensor. For the MAF sensor slide over the red locking clip and press down on the connector to pull out the wire harness.

4. Use a flat head screwdriver or 5/16" nut driver and loosen the hose clamp on the turbo inlet and air intake tube. Remove the air intake tube from the vehicle.



IAT



MAF



5. Unsnap the two clips securing the lid to the air box.

6. Remove the air box lid and air filter underneath.

7. There are three mounting bolts securing the air box to the vehicle underneath the filter. Completely remove the top mounting bolt on the side. **Note:** This bolt will be reused. The two bolts on the bottom tray only needs to be loosen, not removed completely.



Remove, will be reused

Loosen

SEE EXPLODED VIEW ON PAGE 5





## INSTALLATION INSTRUCTIONS (CONTINUED)

8. Push out the stock fender inlet from the stock air box. **Note:** There is a plastic clip holding sensor harness on the side of the box. Be careful not to yank the box out.



9. Rotate the box until you can get see the clip underneath. Use pliers to collapse the clip and push it out.



10. Remove the stock air box from the vehicle.



11. Remove the stock fender inlet from the vehicle.



12. Remove the bushing and grommet from the stock air box and install it into the Air Box (A). Remove the bushing first and then the grommet. Install in reverse order.



13. Insert the Box Seal (B) into the Air Box (A).



14. Insert the Fender Seal (C) into the Air Box (A). Push the seal all the way into the box.



15. Press the two Grommet (E) onto the bottom of the Air Box (A).



16. Determine whether or not you want the Box Plug (P) installed on your Air Box (A) For those concerned about minimal engine heat; insert the box plug into the side of the air box. For those seeking additional air flow, set the box plug aside. **Note:** the box plug can be installed/removed with the intake kit fully installed.



17. Use a screwdriver to remove the air temp sensor and MAF sensor from the stock air lid and install them onto the Air Tube (D) with the three provided Screws (R). Make sure the air temp and MAF sensor o-rings are in place when installing them.



18. Slide the Coupler (Q) and the two Hose Clamps #60 and #56 (J & K) onto the Air Tube (D). Leave both hose clamps loose.



SEE EXPLODED VIEW ON PAGE 5





## INSTALLATION INSTRUCTIONS (CONTINUED)

19. Install the Air Box (A) into the vehicle with the provided Screw (G) and Washer (F). Reuse the screw removed from Step 7 to secure the box to the third mounting point. Do not fully tighten the screws yet.



20. Fold the Fender Seal (C) outward to get the fender seal lip to go underneath the fender flange and flush against the fender side. Hold the Air Box (A) firm against the fender and use a 10mm and 13mm to tighten all three screws.



21. Insert the Intake Tube (D) into the air box up until it reaches the stopper.



22. Place the Air Filter (H) into the Air Box (A) and insert the air filter onto the intake tube. Tighten the #72 Hose Clamp (I).



23. Install the Coupler (Q) and Intake Tube (D) onto the turbo inlet. Tighten the #60 and #56 Hose Clamps (J & K).

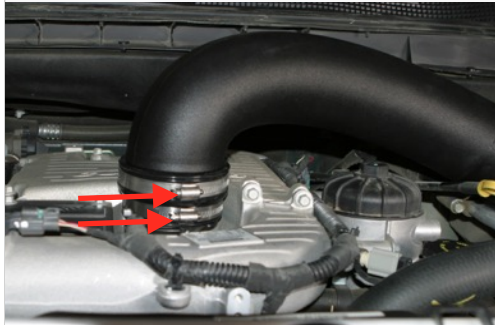

24. Peel off the protecting covering on both sides of the Clear Lid (L). Install the Lid Seal (M) around the clear lid.



25. Place the Clear Lid (L) on top of the Air Box (A) and use the supplied Screws (O) and Washers (N) to secure the clear lid.



26. Push in the plastic clip that was removed in Step 9 into the hole on the side of the Air Box (A).



27. Reconnect the harness to the IAT and MAF sensor. Do not forget to slide back the locking clip of the MAF sensor.



28. Reconnect the negative terminal on both batteries. Inspect your installation, make sure the kit is properly positioned and all fasteners are secure. The installation is now complete.



SEE EXPLODED VIEW ON PAGE 5

## INSTALLATION INSTRUCTIONS (CONTINUED)

### RELATED ITEMS FOR YOUR PURCHASE

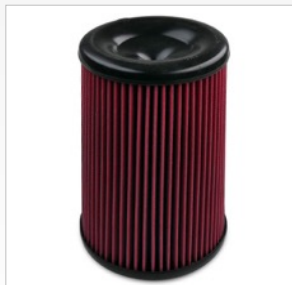

Replacement Cotton Filter  
SKU# KF-1063



Replacement Dry Filter  
SKU# KF-1063D

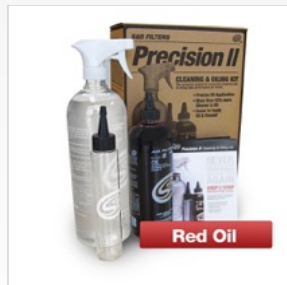

Precision II: Cleaning & Oil Kit  
SKU# 88-0008

Order online today at [www.sbfilters.com](http://www.sbfilters.com) or through your local S&B distributor.

### PERFORMANCE TESTING

- Engage parking brake and start your engine. Listen for abnormal noises. If an air leak is detected, re-inspect hoses and connections as they may need to be repositioned and tightened.
- S&B FILTERS recommends that you keep your OE intake system in the event it is required in the future.
- In order to maintain your warranty, all connections and components must be checked periodically for alignment and for proper tension on all connections. Failure to do so may void your warranty.
- Use only S&B FILTERS cleaning and oil products to service your filter. Using any other brand oil and or cleaners on your S&B air filter may void your warranty.

### WARNING!

If your vehicle has a Vehicle Emission Control Information decal affixed to the factory airbox, a new replacement label must be obtained and installed in a readily visible position in the engine compartment in order to remain CARB compliant. Failure to do so will prevent the vehicle from passing a smog check. Replacement labels can be ordered from your local dealership. Regulations state that the VECI label shall not be affixed to any equipment which is easily detached from the vehicle. Label placement, under the hood on a painted surface is recommended.



### EMISSIONS STANDARD

The California Air Resource Board (CARB) requires that an E.O. identification label be applied to the vehicle in order to pass a smog check inspection when a Performance Intake Kit has been installed. You must place the E.O. label provided on or near the intake kit after installation so that a smog check technician can easily verify the E.O. number. As of April 2009, S&B has never had a product where CARB denied an exemption request; however, the exemption process with CARB can take as long as 18 months. Check the status of the exemption process by looking up a specific part number at [www.sbfilters.com](http://www.sbfilters.com). The CARB Exemption number and/or status is listed under the Product Details section for each part number. If the status shows as "Pending," CARB has yet to issue an exemption. Products that have not been issued an EO number are street legal in most states, but may not be used on emission controlled vehicles in the state of California and are for off road use only. If you purchased your kit from S&B Filters directly, we will automatically mail you your Exemption Sticker when it is issued to us. If you purchased your kit from an authorized S&B Filters Dealer, log onto our web site and register to receive your Exemption Sticker.

SEE EXPLODED VIEW ON PAGE 5





**EXPLODED VIEW**

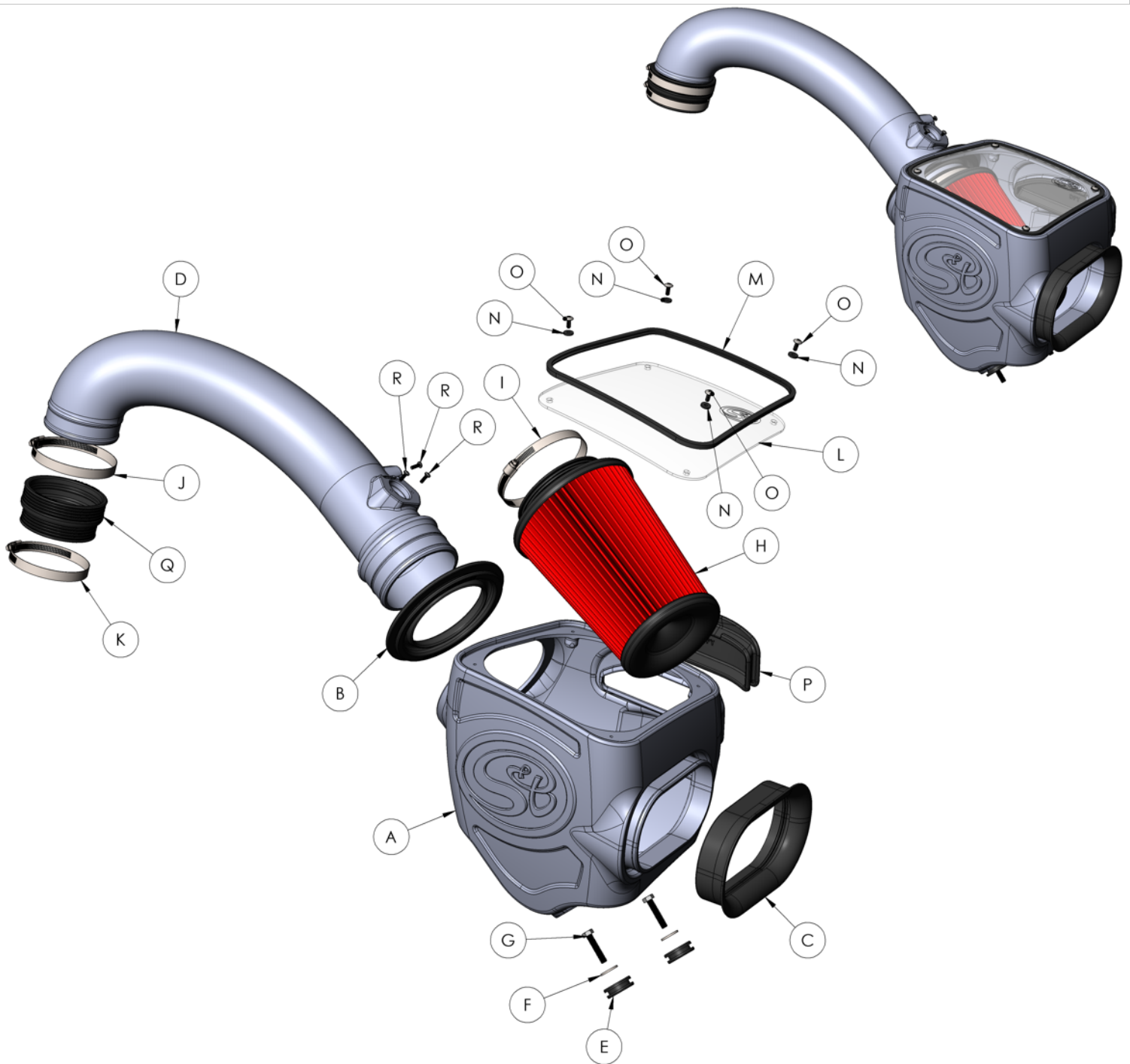

ITEM	QTY.	DESCRIPTION	P/N	ITEM	QTY.	DESCRIPTION	P/N
A	1	AIR BOX	AL1258B-00	O	4	SCREW, #10-24 x .50" TRUSS HEAD PHILLIPS	AI1539-00
B	1	BOX SEAL	AI1650C-00	P	1	BOX PLUG	AI1510C-00
C	1	FENDER SEAL	AI1810C-00	Q	1	STEP COUPLER	AI1581C-00
D	1	INTAKE TUBE	AL1258-00	R	3	SCREW, PAN HEAD PHILLIPS #8-32 x 1/2" LONG	AI1479-00
E	2	GROMMET	AI1618-00				
F	2	WASHER, M8 SS	AI1742-00				
G	2	SCERW, M8-1.25 x 40 HEX HEAD CAP SCREW	AI1163-00				
H	1	AIR FILTER	KF-1063				
I	1	HOSE CLAMP, #72	AG1009-00				
J	1	HOSE CLAMP, #60	AG1008-00				
K	1	HOSE CLAMP, #56	AG1019-00				
L	1	LID	AI1808-00				
M	1	LID SEAL	AI1636-08				
N	4	WASHER, #10 SANTOPRENE	AI1540-00				