



BladeRunner® Charged Air Manifold Installation Instructions: 2003-2007 Dodge Ram Cummins L6-5.9L (td)

advanced FLOW engineering®

P.O. Box 1719
Corona, CA 92879
Support: 951-493-7100
www.aFePower.com

Part Number:
46-10011

Make:
Dodge

Model:
Ram 2500/3500

Year:
'03-'07

Engine:
L6-5.9L (td)

Tools Required:

- 11mm socket or wrench
- 10mm socket or wrench
- 6mm socket
- 8mm allen key
- 5mm allen key
- 3/16" allen key
- 6mm hexagonal bit (provided)
- Gasket remover (scraper)
- Torque wrench
- Ratchet w/ extension

Parts list:

- | | |
|--------------------------------------|---------------------------|
| 1 Manifold, Charged Air | 1 Bracket |
| 2 Screws, socket cap M8 x 1.25 x 160 | 1 Tool 6mm, hexagonal bit |
| 2 Screws, socket cap M8 x 1.25 x 100 | 1 Threadlocker, blue |
| 3 Screws, socket cap M6 x 1 x 8 | |
| 2 Gasket, manifold | |
| 4 Washer, flat M8 | |
| 1 Washer, fender M6 | |
| 2 Plug, 3/8" NPT | |
| 2 Plug, 1/8" NPT | |



Complete Kit w/ Parts



Step 1
Stock Intake Manifold.

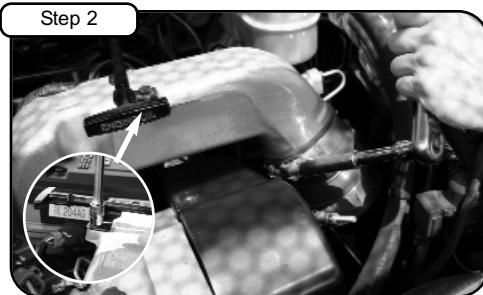

Step 2
With a 11mm socket with ratchet, loosen the intercooler coupler hose clamp. With 10mm socket, remove the bolt holding engine oil dipstick.

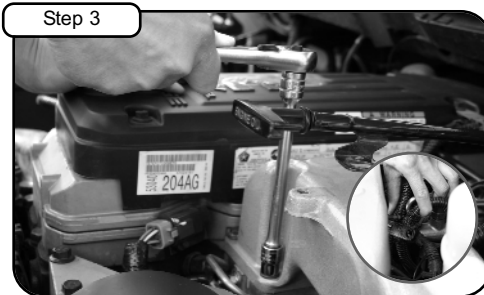

Step 3
With 10mm socket and extension, remove the 4 bolts holding the stock manifold. Remove the engine wiring harness connections in back of stock manifold. Pull harness bracket off mounting stud.

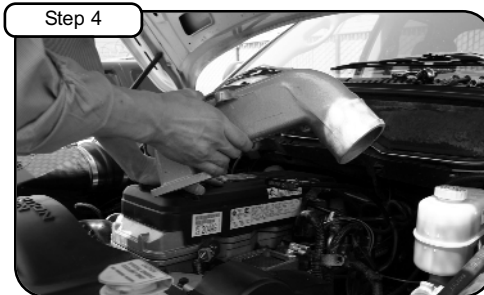

Step 4
Carefully remove stock manifold out of vehicle. (Place a clean shop rag over air grid heater to prevent anything from entering)

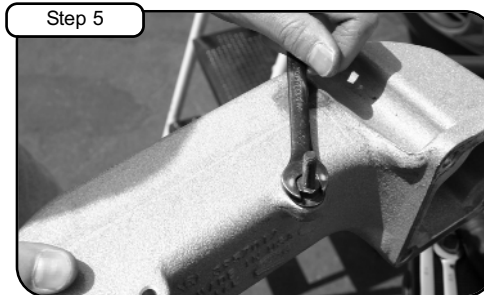

Step 5
With 10mm wrench, remove the engine wire harness bolt from the back of the stock manifold. Place to the side for later install.

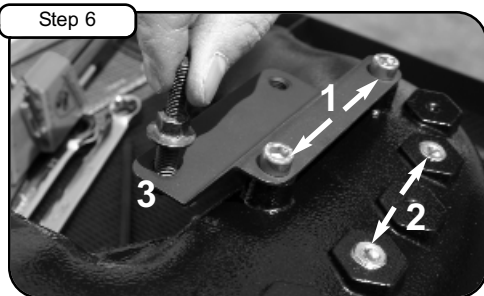

Step 6
1) Install bracket w/ M6 socket cap screws provided. Torque using 5mm allen key. 2) Install 1/8" NPT plugs to aFe manifold using 3/16" allen key. 3) Install engine wire harness bolt to from step 5 to bracket. (See notes 1, 2 & 3)



Step 7
Insert the 2 shorter M8 socket cap screws through aFe manifold. Hold washer against inside mounting flange of aFe manifold and feed screw completely through. Insert the two longer M8 screws w/ washers through the outside mounting bosses.

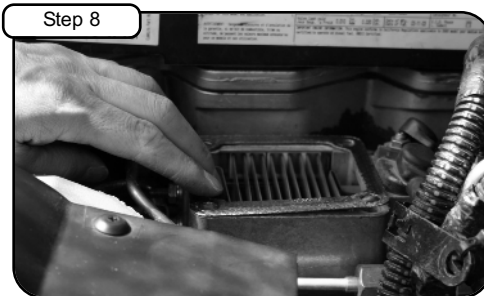

Step 8
Remove both top and bottom stock gaskets away from air grid heater. Replace with new gaskets provided. (May require a scraper or scotch brite to clean sealing surfaces.)

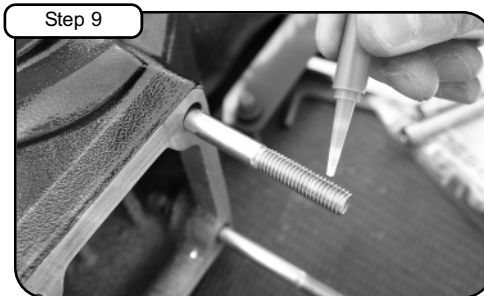

Step 9
Apply threadlocker to the four mounting bolts.



Step 10
Carefully install aFe manifold into vehicle. Guide bolts through gaskets and air grid heater. Insert aFe manifold into intercooler coupler hose.



Step 11
With 6mm hexagonal bit provided and 6mm socket, install the four mounting bolts. Do not tighten completely!

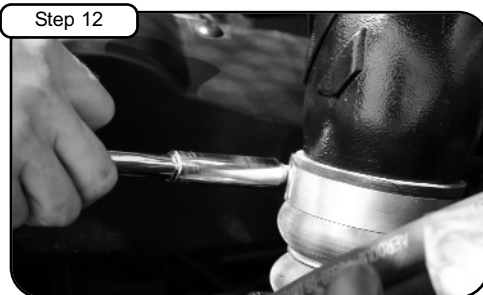

Step 12
Tighten coupler hose clamp with 11mm socket (See notes 2 & 4). Tighten the four mounting bolts from Step 11 (See notes 2 & 5).

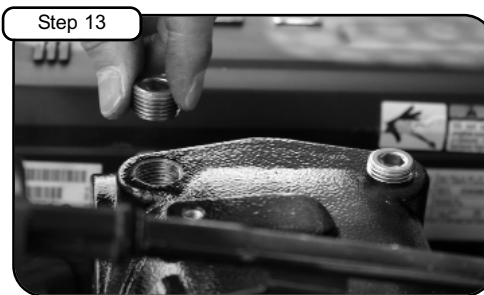

Step 13
Install the two 3/8" NPT plugs to top of aFe manifold. Tighten using 8mm allen key (See notes 1, 2 & 5).



Step 14
Install the engine oil dipstick using M6 fender washer and socket cap screw provided. Tighten using 5mm allen key (See notes 1, 2 & 3). Attach the engine wire harness to the aFe manifold.



Step 15
Your installation is now complete. Please check all bolts and screws periodically. Re-tighten if necessary. Thank you for choosing aFe!

Notes: 1) Use provided Threadlocker (P/N 03-50162) on all bolts and screws. 2) DO NOT over-tighten bolts. Please tighten to correct torque spec(s). advanced FLOW engineering® is not responsible for improper install.

3) Apply 7 N-m (62 in. lbs.) torque. 4) Apply 8 N-m (71 in. lbs.) torque. 5) Apply 24 N-m (18 ft. lbs.) torque.

California vehicle code sections 27156 and 38391 prohibit the advertising, offering for sale, or installation of any device, which modifies a vehicle's emission control system unless exempted. Unless otherwise noted, aFePower have not received an exemption from these code sections and are not legal for sale or use in California on vehicles originally equipped with pollution-control devices. It is illegal, except for racing vehicles, which may never be driven upon a highway, to remove or otherwise render inoperative any emission control device on regulated motor vehicles. Check the aFe website to ensure proper application.