



BladeRunner® Charged Air Manifold Installation Instructions: 1998.5-2002 Dodge Ram Cummins L6-5.9L (td)

advanced FLOW engineering®
P.O. Box 1719
Corona, CA 92878
Support: 951-493-7100
www.aFepower.com

Part Number: 46-10021	Tools Required: 11mm socket or wrench 10mm socket or wrench 8mm allen key 3/16" allen key 6mm hexagonal bit (provided) Gasket remover (scraper) Torque wrench Ratchet w/ extension	Parts list: 1 Manifold, Charged Air 2 Screw, socket cap M8 x 1.25 x 160 2 Screw, socket cap M8 x 1.25 x 100 2 Gasket, manifold 4 Washer, flat M8 2 Plug, 3/8" NPT 2 Plug, 1/8" NPT 1 Screw, socket cap M8 x 1.25 x 16	1 Tool 6mm, hexagonal bit 1 Threadlocker, blue
---------------------------------	---	--	---



Complete Kit w/ Parts



Step 1
Stock Intake Manifold.

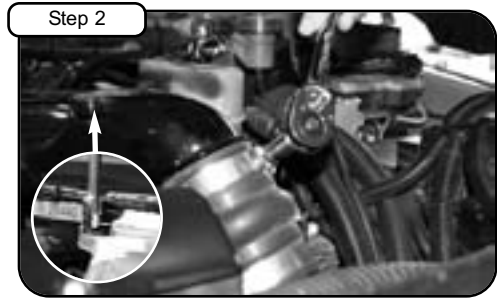

Step 2
With a 11mm socket with ratchet, loosen the intercooler coupler hose clamp. Remove the engine oil dipstick screw with 10mm socket.



Step 3
Pull back OE hump coupler and set aside.



Step 4
With 10mm socket and extension, remove the 4 screws holding the stock manifold.



Step 5
Carefully remove stock manifold out of vehicle. (Place a clean shop rag over air grid heater to prevent anything from entering)



Step 6
Insert the 2 shorter M8 socket cap screws through aFe manifold. Hold washer against inside mounting flange of aFe manifold and feed screw completely through. Insert the two longer M8 screws w/ washers through the outside mounting bosses.

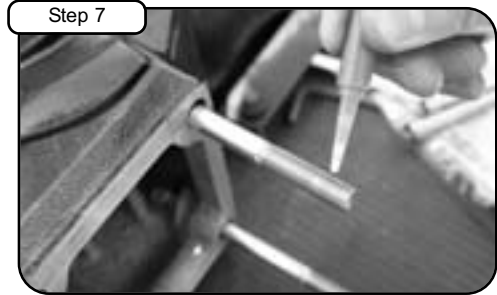

Step 7
Install 1/8" NPT plugs to aFe manifold using 3/16" allen key. Apply threadlocker to the four mounting screws.



Step 8
Remove both top and bottom stock gaskets away from air grid heater. Replace with new gaskets provided. (May require a scraper or scotch brite to clean sealing surfaces.)



Step 9
Carefully install aFe manifold into vehicle. Guide screws through gaskets and air grid heater.



Step 10
Insert aFe manifold into intercooler coupler hose.



Step 11
With 6mm hexagonal bit provided and 6mm socket, install the four mounting screws. Do not tighten completely!

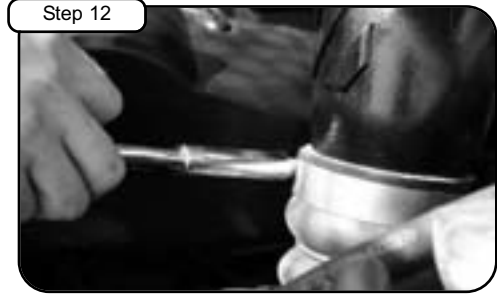

Step 12
Tighten coupler hose clamp with 11mm socket (See notes 2 & 4). Tighten the four mounting screws from Step 11 (See notes 2 & 5).

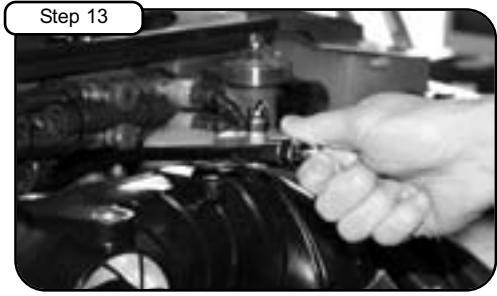

Step 13
Install the engine oil dipstick using M8 socket cap screw provided. Tighten using 6mm allen key (See notes 1, 2 & 3). Attach the engine wire harness to the aFe manifold.

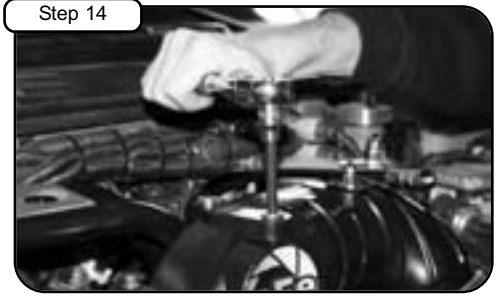

Step 14
Install the two 3/8" NPT plugs to top of aFe manifold. Tighten using 8mm allen key (See notes 1, 2 & 5).



Step 15
Your installation is now complete. Please check all screws periodically. Re-tighten if necessary. Thank you for choosing aFepower!

Notes: 1) Use provided Threadlocker (P/N 03-50162) on all screws. 2) DO NOT over-tighten screws. Please tighten to correct torque spec(s). 3) Apply 7 N·m (62 in. lbs.) torque. 4) Apply 8 N·m (71 in. lbs.) torque. 5) Apply 24 N·m (18 ft. lbs.) torque.

California vehicle code sections 27156 and 38391 prohibit the advertising, offering for sale, or installation of any device, which modifies a vehicle's emission control system unless exempted. Unless otherwise noted, aFePower have not received an exemption from these code sections and are not legal for sale or use in California on vehicles originally equipped with pollution-control devices. It is illegal, except for racing vehicles, which may never be driven upon a highway, to remove or otherwise render inoperative any emission control device on regulated motor vehicles. Check the aFe website to ensure proper application.