

S6248PLM/S6248SLM

11-14 FORD F250/350/450 6.7L POWERSTROKE, FILTER-BACK, CC/SC, 4" SINGLE SIDE

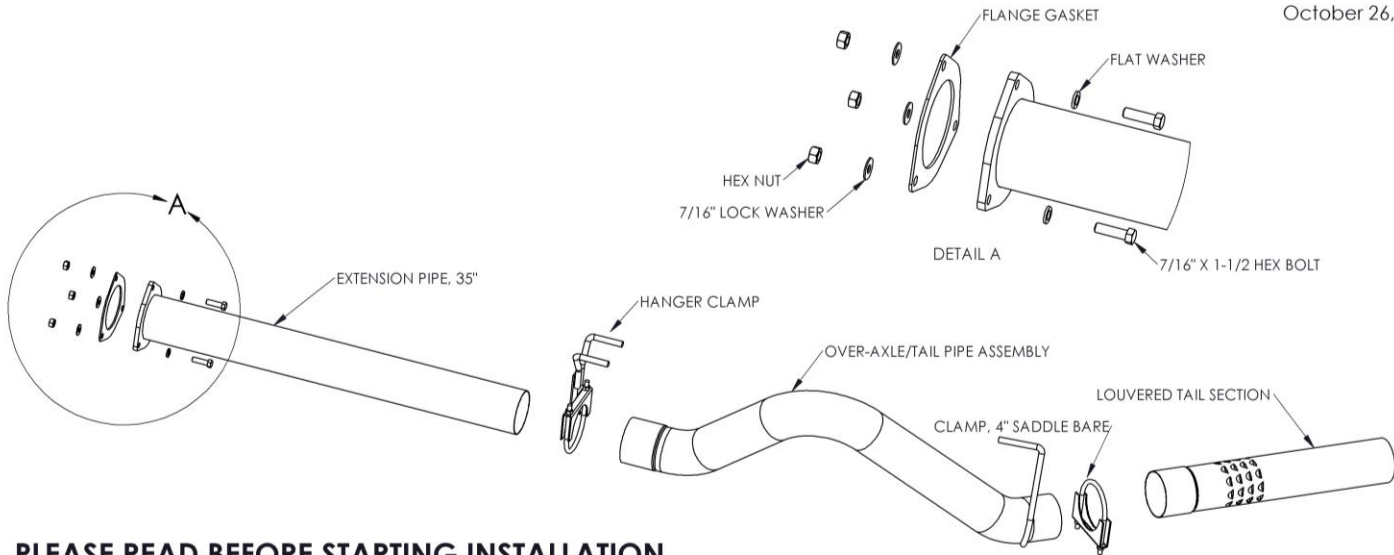

October 26, 2016



PLEASE READ BEFORE STARTING INSTALLATION

MBRP Inc. has made every effort to ensure that this component is of superior quality and properly packaged. It is the installer's responsibility to ensure that the component is complete, including any additional hardware and that it is undamaged. This should be done prior to the removal of factory components. Finally, check that this system properly matches the make and model of the vehicle and will not interfere with previous or planned modifications.

Removal of stock system:

1. Apply a penetrating lubricant liberally to all exhaust fasteners, hangers and rubber insulators.
2. Loosen the three (3) nuts securing the extension pipe flange to the over-axle pipe
3. If applicable, remove the temperature sensor from the over-axle/tail pipe. Remove the factory over-axle/tail pipe.
4. Loosen the three (3) nuts securing the extension pipe to the flange directly behind the exhaust filter and remove the extension pipe.

Installation of MBRP Inc. Performance Exhaust:

1. The **Extension Pipe** is pre-cut for the 172.4" (crew-cab long-box) wheelbase. Cut the **Extension Pipe** to the appropriate length for the installation vehicle.
2. Mate the **Extension Pipe** flange to the stock exhaust flange with the **Flange Gasket** between them and fasten the flanges together with the hardware provided.
3. Fit the **Hanger Clamp** loosely over the end of the extension pipe and insert the hangers into the rubber isolators.
4. Install the **Over-Axle/Tail Pipe** onto the **Extension Pipe**, inserting the hanger into the rearward factory rubber isolator.
5. Install the **Louvered Tail Section** onto the **Over-Axle/Tail Pipe** and secure it with the **4" Clamp** provided.
6. Align the exhaust as required and tighten all connections.
7. Fasten the temperature sensor to the bung on the **Over-Axle/Tail Pipe** if applicable. For 2011-14 models fasten **Bung Plug** in place of temperature sensor.
8. Ensure that there is adequate clearance around the spare tire or any fuel and brake lines.

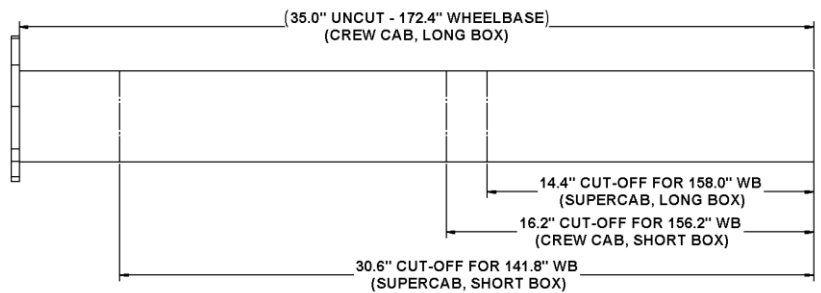

Congratulations! You are ready to begin experiencing the improved performance and driving excitement of your MBRP Inc. performance exhaust system. We know you will enjoy your purchase.