

Installation Steps:

Tools Required:

- 10 MM Socket with Extension
- #1 Phillips Screwdriver
- #2 Phillips Long Screwdriver



1. Review all steps before initiating installation.
2. If applicable, reset the combination lock before beginning installation.
3. Remove factory console lid: Open lid, using a #1 Phillips head screwdriver, remove the five screws holding the inner lid cover. Next, using the #1 Phillips head screwdriver, remove the four screws holding the lid to the hinge bracket. **(See figure 1, 2, 3)**
4. Remove hinge bracket: Notice on either side of the hinge bracket there are covers on the mounting screws holding the hinge bracket to the factory console. Remove these covers and remove the four (4) screws using the #1 Phillips screwdriver. **(See figure 3,4,5)**
5. Using the 10mm socket, remove the two mounting bolts at the bottom of the factory console. **(see figure 6)**
6. Place the safe into the console. Notice the two pre-drilled holes in the bottom of the safe. Using the replacement screw that come with the safe and the #2 long Phillips screwdriver, secure the safe into place. **(see figure 7)**
7. Reassemble factory console lid
8. The installation is now complete!

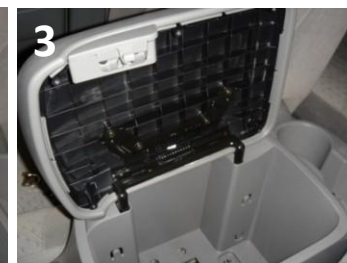

Combination Lock Reset Guides:

Installation Steps:

IMPORTANT: Make sure to set your combination **BEFORE** installing your safe

Before setting your combination, ensure safe door remains **OPEN** to prevent accidental lockout



⇒ [4 Digit Lock User Guide](#)



⇒ [3 Digit Lock User Guide](#)



⇒ [Elite 4-Digit Lock
User Guide](#)