

Installation Steps:

Tools Needed:

- Safety goggles or glasses
- Electronic stud finder (optional)
- Pencil
- Drop Cloth (optional)
- Drill
- 1/8" Drill Bit
- Socket Wrench
- 10mm Socket
- 7/16" or 11mm Socket

Included Hardware:

- 1/4" – 20 X 1-1/4" Self Drilling Screw x4
- 1/4" – 20 X 1/2" Bolt x6
- 1/4" – 20 X 1" Bolt x4
- 1/4" – 20 Lock Nut x4
- 1/4" Washer x4

ATTENTION!

This product can be installed in a wide variety of applications that are not represented in this installation document. These instructions demonstrate two application scenarios, which can also be used as a reference for installing in **other** application scenarios. Limiting factors that could prohibit installation include the following:

Accessibility & Space Limitations: The Universal Safe cannot be installed in places that do not allow access and without sufficient space.

Fastener Positions: The fasteners cannot be installed in material that is insufficient to support the safe's weight and the contents that will be stored within.

Wall Attachment Installation Steps:

1. Read all the instructions before beginning installation.
2. Test fit the safe and bracket before installation. Be sure that there is sufficient room to open and close the door as well as operate the lock (**Image 1**).
3. If possible, use a stud finder to find the nearest stud to the desired application site (**Image 2a**). It is highly suggested that, if possible, the bracket should be attached to a stud whenever possible for the best level of security. Align the bracket closest to the position desired while lining up at least one hole with the stud and mark the location with a pencil (**Image 2b**).

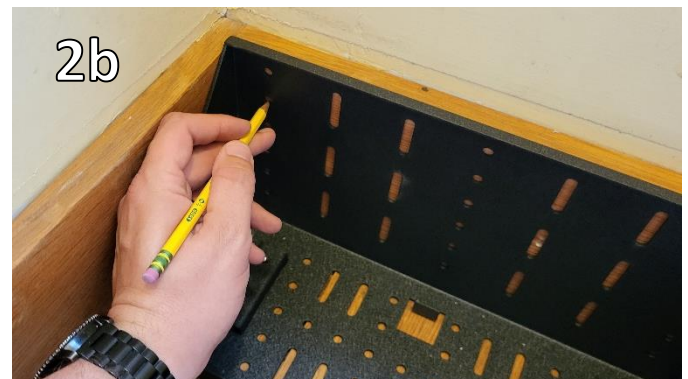

Installation Steps:

Wall Attachment Installation Steps (Cont.):

4. While keeping the bracket in the same position, mark at least 1 more location on the wall as well as 2 locations on the floor (**Image 3**). It is highly suggested that where applicable, there are at least 4 attachment areas to the bracket where 2 are on each side. This will allow for the greatest amount of security.



5. Using the 1/8" drill bit, drill pilot holes in all of the marked location. (**Images 4a and 4b**)

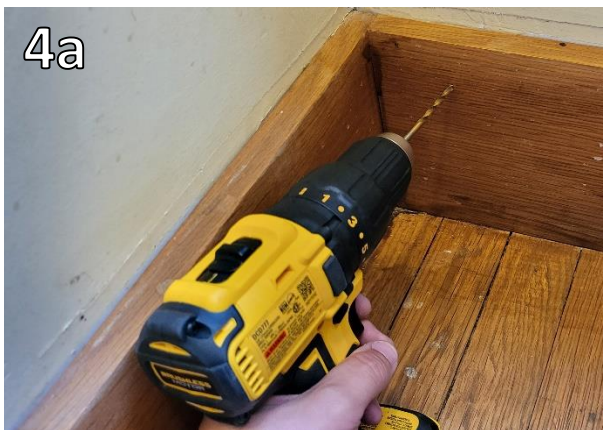

6. Align the bracket with the pre-drilled holes and using a socket wrench and the 10mm socket, attach the included screws through the bracket (**Image 5**). Be sure not to overtighten the screws. Force needed will depend on the type of material that is being attached to.

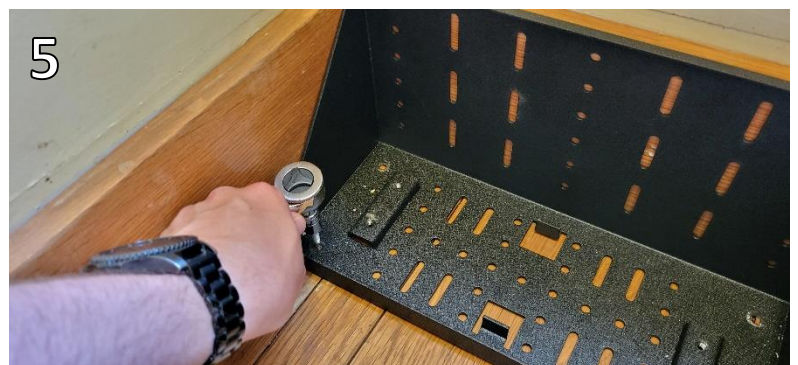

Installation Steps:

Wall Attachment Installation Steps (Cont.):

7. Place the safe on the secured bracket and make sure that the holes in the bottom of the safe align with the nuts in the bracket (**Image 6**). Be sure that the door is opening in the desired direction.



8. Hand start both shorter included bolts through the bin and into the bracket (**Image 7a**). Then, using the socket wrench and the 7/16" or 11mm socket, tighten the bolts (**Image 7b**). The installation is now complete.

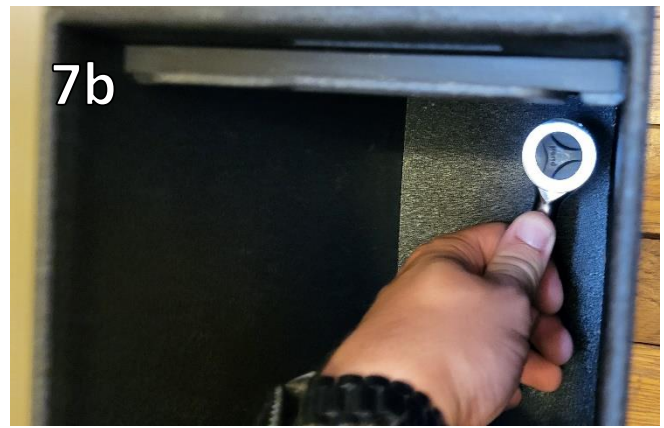
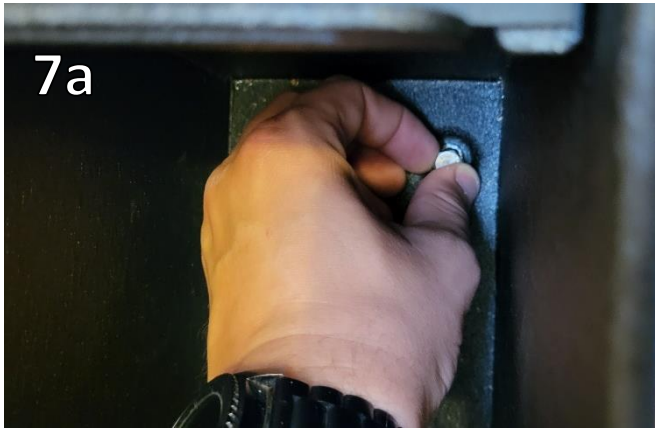

Floor Attachment Installation Steps

1. Read all the instruction before beginning installation.
2. Test fit the safe and bracket before installation. Be sure that there is sufficient room to open and close the door as well as operate the lock (**Image 1**).



Installation Steps:

Floor Attachment Installation Steps (Cont.):

3. When attaching into the only the floor, it is suggested that 4 attachment locations are used. It is also suggested that the bracket is only installed in a sub floor of at least 3/4in thickness to ensure the most secure attachment. Remove the safe from the bracket and mark 4 locations to place the bolts (**Image 2**).

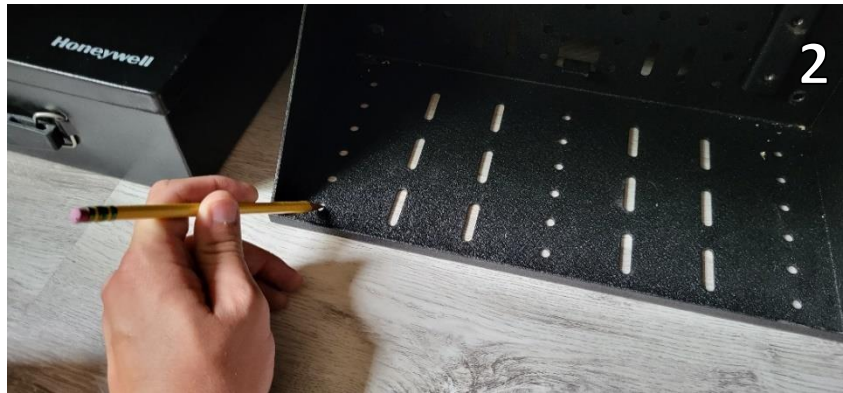

4. Using the 1/8" drill bit, drill pilot holes in all of the marked location. (**Image 3**)



5. Align the bracket with the pre-drilled holes and using a socket wrench and the 10mm socket, attach the included screws through the bracket (**Image 4**). Be sure not to overtighten the screws. Force needed will depend on the type of material that is being attached to.

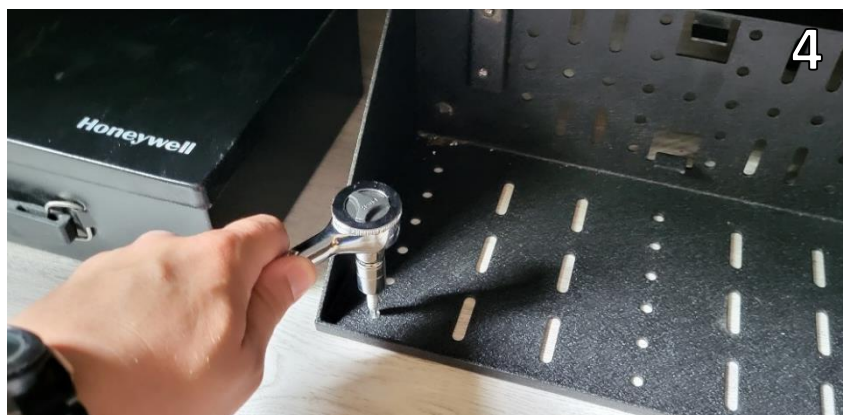

Installation Steps:

Floor Attachment Installation Steps (Cont.):

6. Place the safe on the secured bracket and make sure that the holes in the bottom of the safe align with the nuts in the bracket (**Image 5**). Be sure that the door is opening in the desired direction.



7. Hand start both shorter included bolts through the bin and into the bracket (**Image 6a**). Then, using the socket wrench and the 7/16" or 11mm socket, tighten the bolts (**Image 6b**). The installation is now complete.

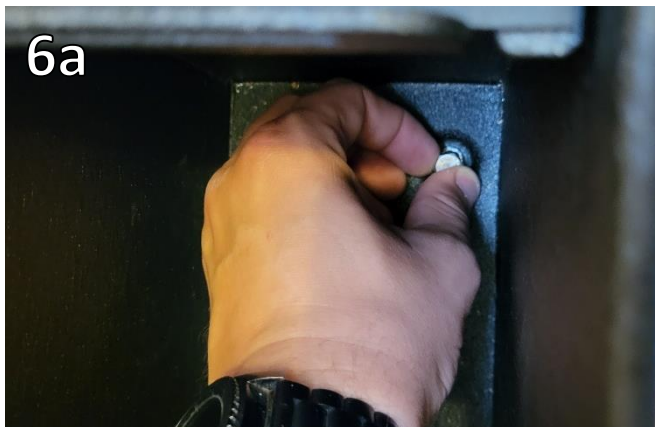

Installation Steps:

Other Potential Applications



Kitchen Cabinet Safe



Filing Cabinet Safe

Combination Lock Reset Guides:

Installation Steps:

IMPORTANT: Make sure to set your combination **BEFORE** installing your safe

Before setting your combination, ensure safe door remains **OPEN** to prevent accidental lockout



⇒ [4 Digit Lock User Guide](#)



⇒ [3 Digit Lock User Guide](#)



⇒ [Elite 4-Digit Lock
User Guide](#)