

**Ford F-Series Bed Safe
Instruction Sheet (2003)**



Tools Needed:

- Drill •T-30 Torx Bit •Torque Wrench •1/2" or 13mm Hex Socket

Features/Accessories incompatible with Bed Safe:
 •All plastic drop-in bed liners •All Advantage brand bed covers

Installation Steps:

1. Read all the instruction before beginning installation. Also, confirm that you DO NOT have the above features.
2. Read Step 2a before proceeding:

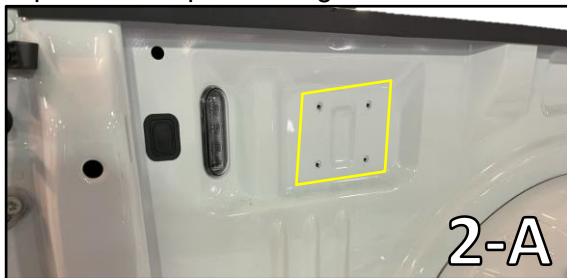

- a) The Bed Safe can be installed on either the left or right side of the truck bed at the 4 mounting holes shown (image 2-A). Go straight to Step 3 if you do not have a Tie-Down Cleat or if the 4 mounting holes are pre-threaded. Perform Step 2b if your vehicle has a Tie-Down Cleat/Bracket pre-installed to the 4 mounting holes. **IMPORTANT: If you have a Spray-In Bed Liner or BedRug Sportliner, please read the instructions on Page 3 before proceeding with the installation.**

- b) Using the drill, unscrew the 4x Torx screws from the Cleat/Bracket (seen in image 2-B). Set aside the Cleat/Bracket; you will not need it for the installation of this Bed Safe. **Discard the 4 mounting screws that were removed; they MUST NOT be reused;** 4x new screws have been provided in the Bed Safe hardware kit.

3. Position the Mounting Bracket over the 4 mounting holes such the mounting slots are vertical. Install an M6 steel washer to each of the Torx screws. Insert a Torx screw through one of the 2 upper slots in the Mounting Bracket, and screw the Torx screw about 75% of the way into one of the 2 upper mounting holes. Repeat for the remaining 3 mounting holes.

4. Allow the Mounting Bracket to hang such that the screws are passing through the uppermost part of each of the mounting slots (you may pull down on the Mounting Bracket if needed – see image 4). Fully screw in all 4x Torx screws to torque 12.0 +/- 1.8 N-m (106 +/- 16 in-lbs). **WARNING! DO NOT OVERTIGHTEN. If the screw is overtightened, the threading of the vehicle mounting hole could be damaged.**

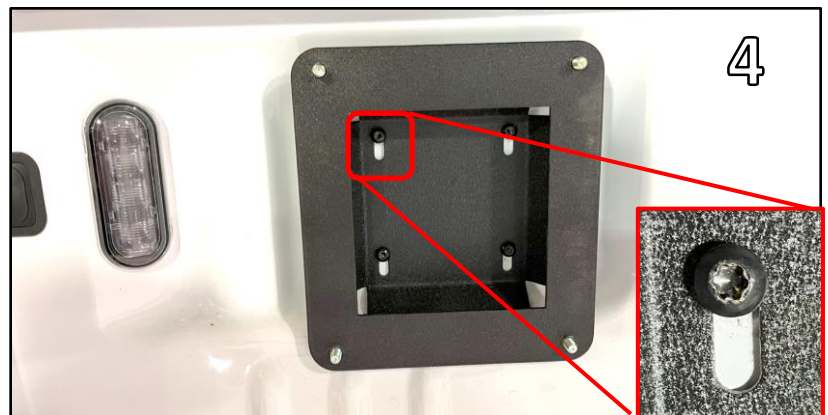

5. Install a Rubber Washer to each of the threaded studs on the Mounting Bracket (4x Rubber Washers total).
6. Unlock the Bed Safe and remove two (2x) foam liners from inside. Keep these to re-insert after installation.

7. **WARNING! Please be cautious while lifting and handling the Bed Safe.** Lift the Bed Safe up to the Mounting Bracket (image 7). Position the Bed Safe to align the 4 threaded studs of the Mounting Bracket with the 4 holes of the Bed Safe. When the Bed Safe is fully seated onto the Mounting Bracket, it is recommended to brace the side of the Bed Safe while performing the next step (Step 8).

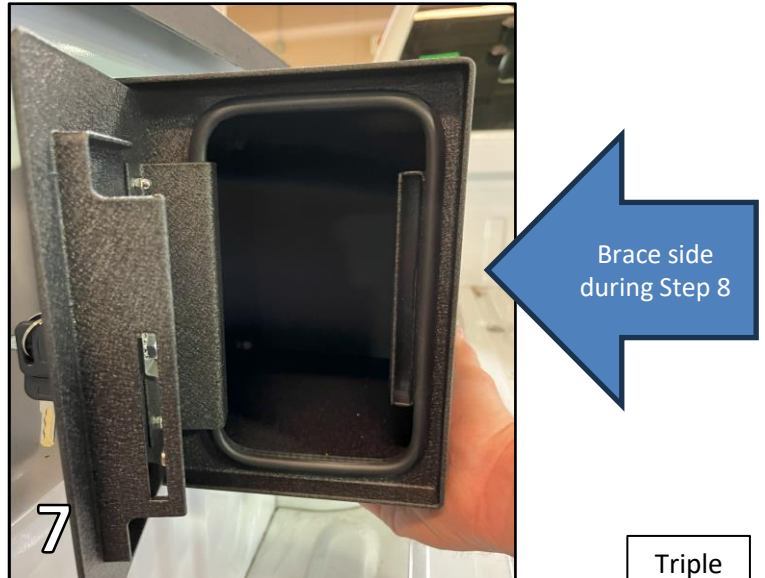

8. Hand thread an M8 Nut onto each of the 2 uppermost studs from inside the Bed Safe. Once these nuts are fully hand threaded, you may stop bracing the side of the safe.

9. Hand thread the two (2x) remaining M8 Nuts onto the threaded studs from inside the Bed Safe (image 9). While the Bed Safe is hanging from the Mounting Bracket, fully tighten all 4 nuts inside of the Bed Safe to torque 5.4 N-m (48 in-lbs).

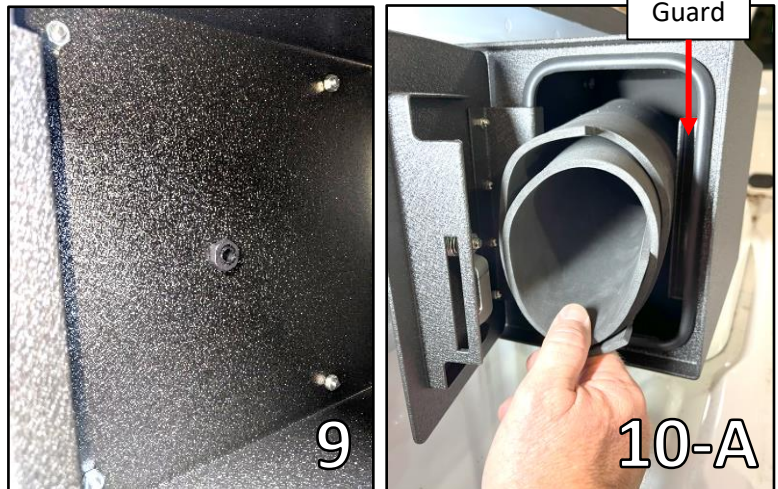

10. Roll up larger Foam Liner and insert it into the Bed Safe (image 10-A). Allow the Foam Liner to expand, and position the large rectangular notch in the Foam Liner to align with the Triple Guard (opposite from the Hinge). Press the sides of the Foam Liner against the inside walls of the Bed Safe. There is an additional tab to secure the Foam Liner under the Triple Guard. The ends of the Foam Liner will meet and interlock in one corner of the Bed Safe. Refer to image 10-B for the shape of the Foam Liner as installed in the Safe.

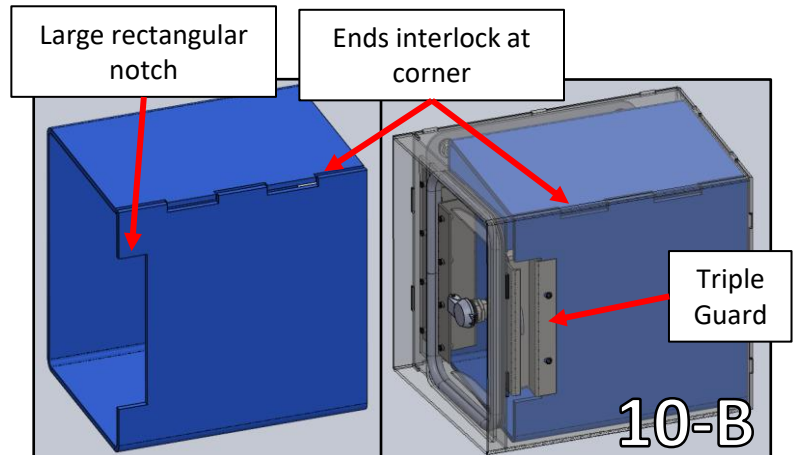

11. Insert the smaller Foam Liner such that it lies flat against the rear wall of the Bed Safe.

12. Insert the QR-Code sheet inside the Safe. Close the door and lock the Bed Safe. When locking and unlocking the door, it is necessary to push the door toward the Safe while turning the key due to the pressure of the water-resistant seal.

13. The F-Series Bed Safe is now installed!

Foam Liner Installed Shape (Safe hidden)

Foam Liner Installed Shape (Safe translucent)

If your F-Series Truck Bed is coated in Spray-In Bed Liner, or has a BedRug Sportliner installed, it is necessary to take the following steps to ensure the Safe is installed correctly and safely. The Safe must mount with no extra material in between the Bracket and the wall of the Truck Bed, otherwise there is risk of the mounting screws loosening over time.

1. Using a ruler and silver or other high-visibility marker, mark a rectangular area as demonstrated in the image below: The upper edge of the rectangle should meet the radius edge approximately 1 inch above the holes, and the lower edge should meet the radius edge approximately 1 inch below the holes (see left image). The left and right edges of the rectangle should be 1 inch away from the holes (see right image). The final rectangle should resemble the yellow rectangle in the right image below.
2. For Spray-In, peel away any Spray-In Bed Liner material using a plastic scraper tool that will not damage the vehicle paint underneath. Remove any Spray-In material within the rectangular boundaries you marked. This will ensure the mounting area is safe for installation. For BedRug, cut out the rectangular area that was drawn. If there is any additional interference on the angled surfaces above or below the holes, cut away more material.
3. The Bracket will now have direct contact with the Bed Wall when installed. Proceed with Step 3 in the instructions on **Page 1**.

